



ORLAND PARK

PUBLIC WORKS DEPARTMENT
15655 RAVINIA AVENUE
ORLAND PARK, ILLINOIS 60462
708-403-6350
FAX 708-403-8798
publicworks@orlandpark.org

PERMIT # _____

TREE REMOVAL PERMIT

Please complete the following form and attach the required documents. Permit review typically takes 3-5 business days. Sample drawing is attached on the back of this permit application. Mitigation requirements can be found on the back of this sheet and in the Land Development Code, Section 6-305 *LANDSCAPE AND TREE PRESERVATION* **PERMIT FEE: Free**

Applicant Name: _____ Phone: _____

Address: _____

Email: _____

Print Contractor Business Name: _____

Property: Single Family Home Multi-Family Non-Residential Parkway

Tree Removal Request:

- 24"+ Diameter (DBH -see page 2) Tree
- Conservation Easement Tree
- Tree planted per a Board Approved landscape plan
- Utility Easement Tree (non-residential)
- Parkway Tree *

Tree Removal Permit Submittal Requirements:

- A legible copy of your plat of survey or site plan that clearly denotes the trees to be removed and the trees proposed to mitigate the tree removal (see sample diagram on next page). Please include location of overhead utility lines, easements, buildings, pools, sheds, accessory buildings, etc.
- Photographs of existing trees.

Proposed trees to be removed: Include quantity, species, size and condition. (Arborist Certification of tree species and condition may be required.)

Proposed Tree Mitigation or Fee-In-Lieu: (All proposed mitigation trees to be planted within 30 days of tree removal. Fee-In-Lieu must be paid prior to tree removal)

Reason for tree removal: _____

***PARKWAY TREE:** For a dead or diseased tree, contact the Public Works Department at 708-403-6350. Healthy parkway trees cannot be removed without approval and tree mitigation.

Applicant Signature: _____ Date _____

VILLAGE USE:

Approved Denied _____ By: _____ Date _____

Parkway Tree – PW Approval By: _____ Date _____

Diameter at Breast Height, or DBH, is the standard for measuring trees. DBH refers to the tree diameter measured at 4.5 feet above the ground. The Village loans out "D-Tapes" (Diameter Tapes) that can be used to measure DBH. Alternatively, DBH can be measured as follows using a string, a measuring tape, a thumb tack and a calculator:

1. With the measuring tape, measure 4.5 feet up the trunk of the tree from the ground.
2. Use a thumb tack to mark the height on the tree.
3. Wrap your string around the tree trunk at 4.5 feet. Make sure the string is straight and tight around the trunk, and mark the circumference on the string.
4. Measure the length of string to get the circumference of the tree.
5. Convert the circumference measurement to diameter (DBH) by dividing the circumference by 3.14 (pi).

EXAMPLE: Circumference = 40 Inches
 $40 / 3.14 = 12''$ DBH

**SAMPLE ONLY
 CANNOT BE USED FOR PERMIT APPLICATION**

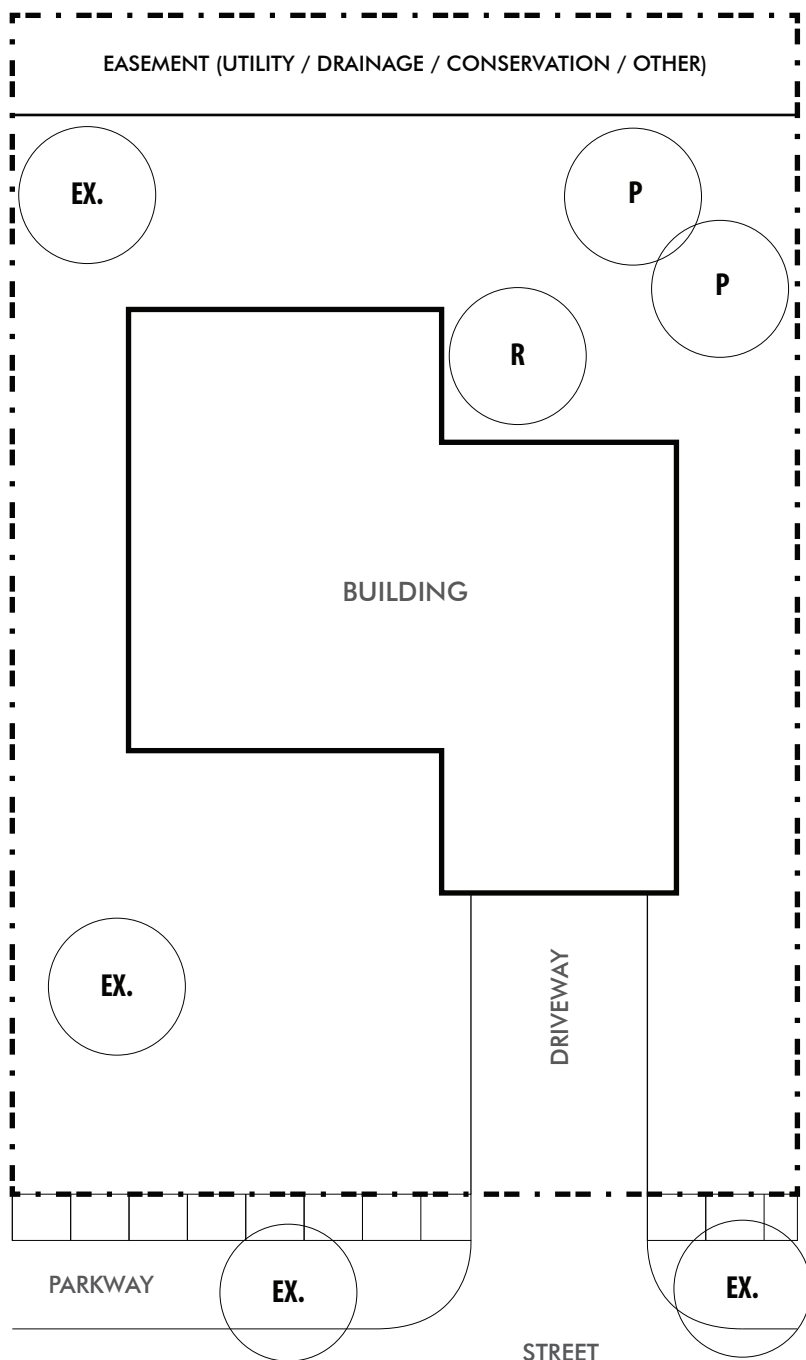

Table 6-305.F.3.f.1 (A) - Tree Replacement Standards

Table 6-305.F.3.f.1 (A): Tree Replacement Standards	
CANOPY TREES	
Diameter of Removed Trees	Number of Replacement Trees Required per Every (1) Tree Removed
4" to 12"	3 trees at 1.5", 2 trees at 2.5" or 1 tree at 4"
13" to 23"	6 trees at 1.5", 4 trees at 2.5" or 2 trees at 4"
24" or greater	8 trees at 1.5", 6 trees at 2.5" or 3 trees at 4"
EVERGREEN TREES	
Height of Removed Trees	Number of Replacement Trees Required
6' to 10'	2 trees at 6' or 1 trees at 10'
10' to 14'	4 trees at 6' or 2 trees at 10'
14' or taller	6 trees at 6' or 3 trees at 10'

Tree of Heaven (*Alianthus* spp.), Buckthorn, Willow, Box Elder, Silver Maple, Osage Orange, all species of Ash (*Fraxinus* spp.) and Cottonwood (*Populus deltoides*) are exempt from mitigation requirements.

EX = EXISTING
R = TO BE REMOVED
P = PROPOSED REPLACEMENT